



# Meeting Space

## MEETING SPACE - LEVEL 1



ROOM	DIMENSIONS	SQ. FT.	THEATRE	CLASSROOM	BANQUET
100 A	36 X 18	648	57	30	30
100 B	36 X 18	648	57	30	30
100 A & B	36 X 36	1248	135	60	70
101 A	32 X 30	960	110	48	60
101 B	31 X 30	930	92	36	50
101 A & B	63 X 30	1890	174	90	100
102 A	44 X 48	2112	240	108	110
102 B	32 X 48	1536	154	72	90
102 C	63 X 48	3024	330	168	180
102 A & B	76 X 48	3648	420	180	240
102 B & C	95 X 48	4560	520	225	260
102 A, B, & C	139 X 48	6672	740	396	400
103	28 X 42	1176	120	63	60
104 A	23 X 42	966	110	42	60
104 B	24 X 42	1008	110	42	60
104 A & B	47 X 42	1974	230	108	120
COURTYARD	26 X 147	3822			

*Ceiling Height - Rooms 100, 101, 103 & 104: 14ft. • Room 102: 15ft.*

## MEETING SPACE - LEVEL 2

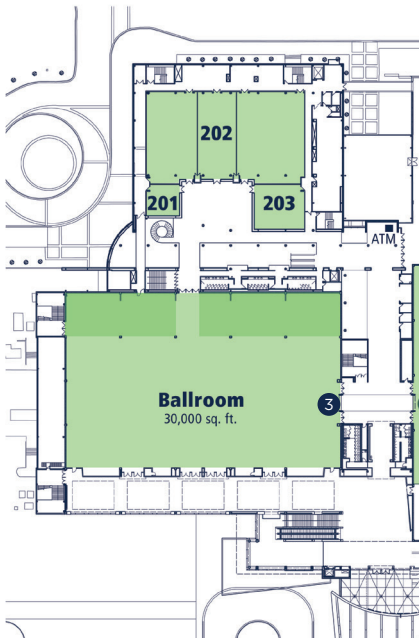

ROOM	DIMENSIONS	SQ. FT.	THEATRE	CLASSROOM	BANQUET
201	28 X 30	840	98	42	40
202 A	48 X 79	3792	400	198	220
202 B	32 X 79	2528	266	144	140
202 C	64 X 79	5056	570	270	290
202 A & B	80 X 79	6320	684	330	380
202 B & C	96 X 79	7584	840	405	440
202 A, B, & C	144 X 79	11376	1254	621	700
203	41 X 45	1845	200	105	110
BALLROOM	250 X 120	30000	3000	1700	1700

*Ceiling Height - Rooms 201 & 203: 14ft. • Room 202: 17ft. • Ballroom: 24ft.*

## EXHIBIT SPACE

- Conference Hall - 50,000 sq. ft.
- Hall 1 - 125,000 sq. ft.
- Hall 2 - 105,000 sq. ft.



# Door Specifications

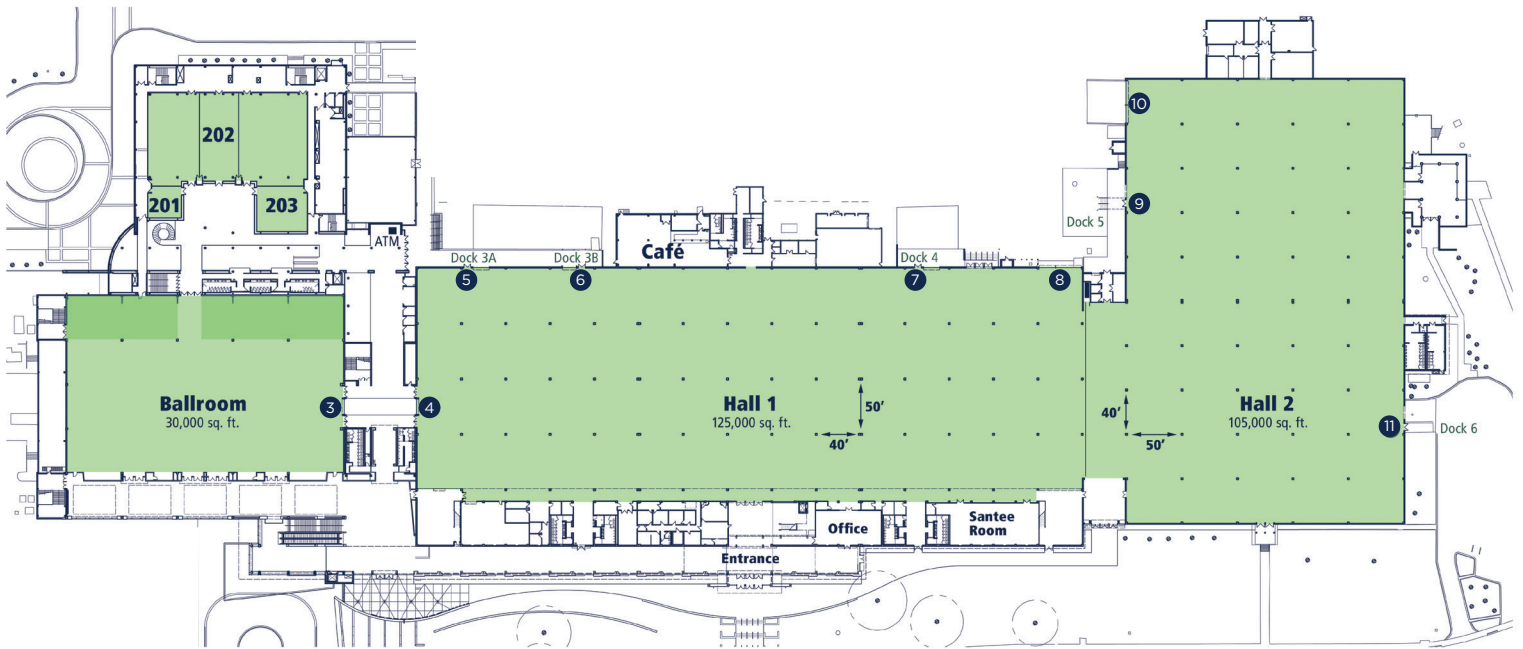

① DOOR SPECIFICATIONS	DOCK CAPACITIES
② Conference Hall Dock Door - 15' W x 14' H	3 Trucks
③ Drive-In Door - 18' W x 8' H	
④ Drive-In Door - 14' W x 15' 10" H	
⑤ Drive-In Door - 14' W x 15' 10" H	
⑥ Dock 3A - 14' W x 16' 6" H	7 Trucks
⑦ Dock 3B - 12' W x 14' H	
⑧ Dock 4 - 12' W x 14' H	4 Trucks
⑨ Drive-In Doors - 38' 8" W x 16' H *Full 38' requires center post removal	
⑩ Dock 5 - 12' W x 14' H	2 Trucks
⑪ Drive-In Doors - 38' 8" W x 16' H *Full 38' requires center post removal	
Dock 6 - 12' W x 14' H	1 Truck



# Exhibit Hall

**Exhibit Hall - LEVEL 1**

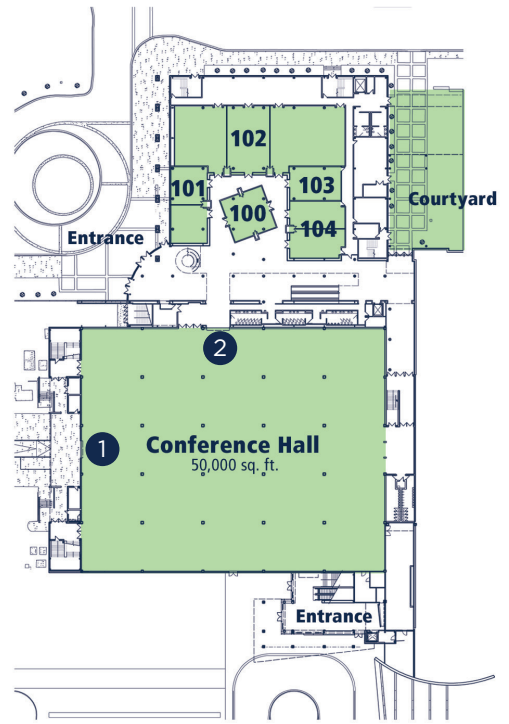

**Exhibit Hall - LEVEL 2**

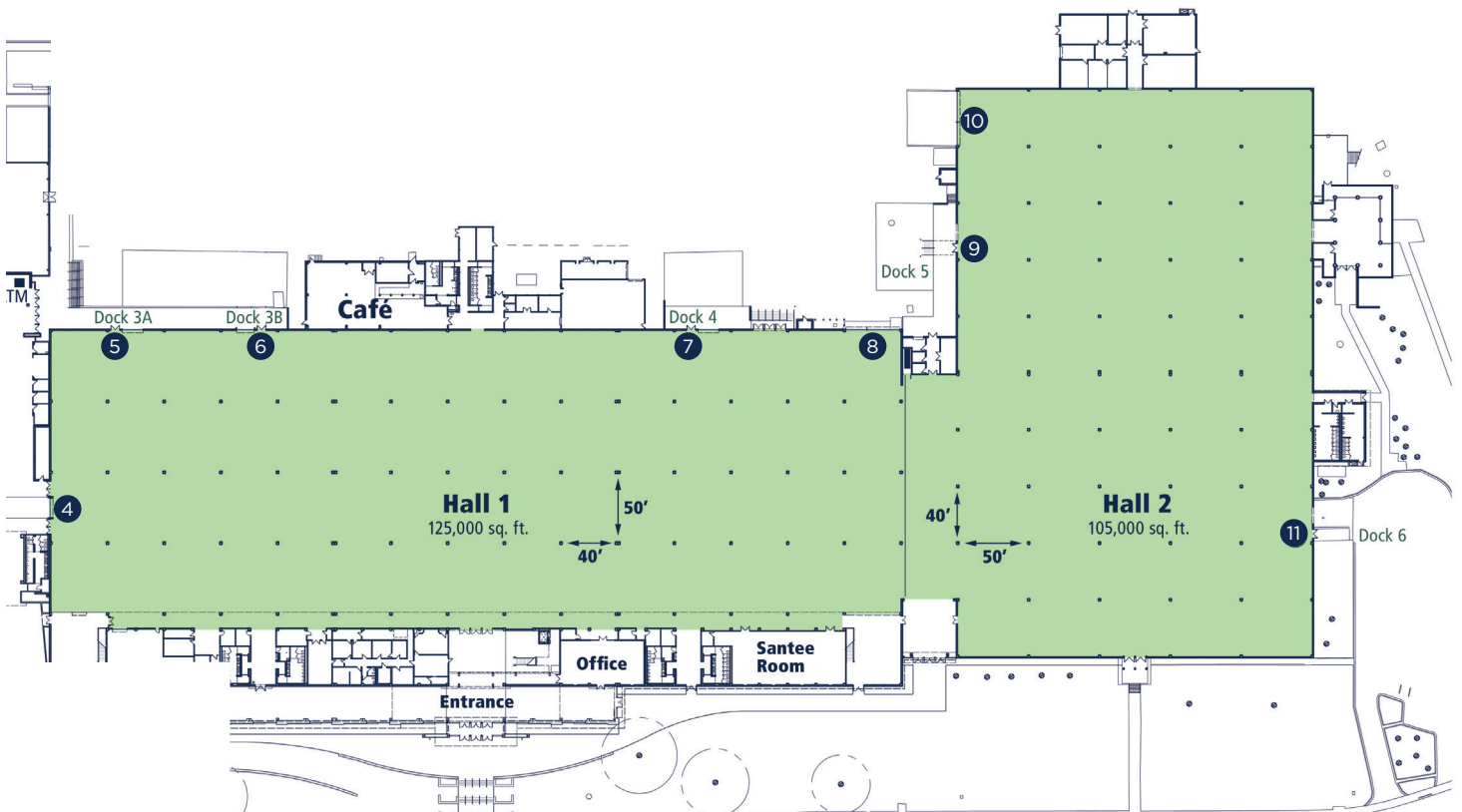



# Parking & Facility Access

